



OAK PARK UNIFIED SCHOOL DISTRICT  
5801 East Conifer Street, Oak Park, California 91377  
Telephone: (818) 735-3254 ♦ Facsimile: (818) 865-8467

---

## BUSINESS AND ADMINISTRATIVE SERVICES

---

TO: Members, Board of Education  
Dr. Anthony W. Knight, Superintendent

FROM: Martin Klauss, Assistant Superintendent  
Business and Administrative Services

DATE: March 14, 2015

SUBJECT: AGENDA BACKGROUND – ITEM B.2.A APPROVE RECOMMENDATION FOR PLAYGROUND  
SHADE STRUCTURE INSTALLATION

---

At its meeting on October 21, 2014, the Board directed staff to provide shade structures for the playground apparatus at each of the District's elementary schools as a condition of implementing the new early-start school year calendar in 2015-16. In response, the Administration has prepared this recommendation for playground shade structure installation. The recommendation includes shade sails at all three elementary schools, plus umbrella shade structures to be placed over the playground apparatus located on the lower field at Brookside Elementary School. In the following pages, the types and placement of the shade sail and umbrella structures are illustrated. Estimated project costs and funding sources are outlined below:

### ESTIMATED PROJECT COST:

#### Brookside = \$82,824

- Two umbrellas (20ft and 26ft) on for the existing play equipment = \$23,685
- 4 point sail structure on the upper primary playground (including ADA upgrade) = \$59,139

#### Oak Hills = \$81,386

- 4 point sail structure on the elementary playground (including ADA upgrade) = \$81,386

#### ROES = \$81,877

- 3 point sail structure on the kindergarten playground (including ADA upgrade) = \$31,291
- 4 point sail structure on the elementary playground (including ADA upgrade) = \$49,886

Total Equipment Cost = \$246,087

Architect/Inspector of Record (15%) = \$36,913

Contingency (15%) = \$36,913

**COST GRAND TOTAL = \$319,913**

TOTAL FUNDING RESOURCES:

- Parent-Teacher Organization Donations (15%) = \$36,913
  - BES - \$12,424
  - OHES - \$12,208
  - ROES - \$12,281
- 2015-16 One Time Funding (General Fund) = \$100,000
- Measure R Bond Fund = \$183,000

FUNDING GRAND TOTAL = \$319,913

- ALTERNATIVES:
1. Approve the staff recommendation for playground shade structure installation at the District's elementary schools.
  2. After discussion, direct staff to modify the recommendation for playground shade structure installation.
  3. Do not approve the staff recommendation.

RECOMMENDATION:      Alternative No. 1

# Brookside

## Shade Structure + Umbrellas





# Brookside

## 4 Point Sail Shade Structure

- Structure Size - 30' x 60'
- Number of Posts - 4
- Number of Fabric Tops - 1
- Fabric Type - Colourshade FR
- Fabric Color - Steel Color
- Post Attachment Method - Embed
- Entry Height - 8/12
- Wind load - 85 mph
- Total:

**\$45,589.28**

Asphalt Play Area





# Brookside Primary - Umbrella Option (no ADA required)

Play Cover 26' Single Post Umbrella  
Integrated shade 5" OD Post for 6'6" Play  
Cover - **Umbrella Cost - \$10,883.93**

Structure Modification – **Construction**  
**Costs - \$2,000.00**

**TOTAL COST = \$12,883.93**

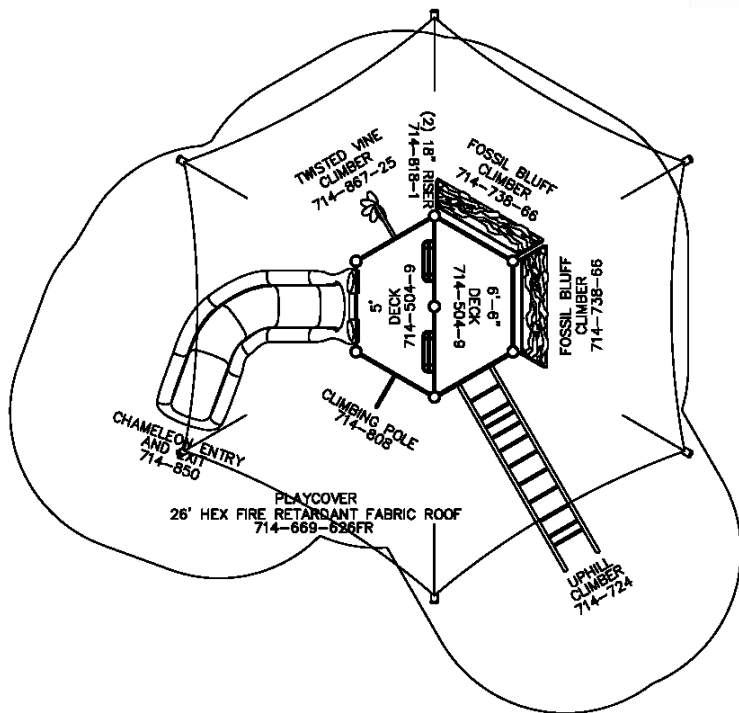

# Brookside Fitness - Umbrella Option (no ADA required)

Fitness Area Kids Choice square deck 5"  
OD X 219" Post for 5' DECK w/Topper 20'  
Pyramid Integrated Play Cover -

**Umbrella Cost \$7600.55**

**Structure Modification –**

**Construction Cost \$3,200.00**

**TOTAL COST = \$10,800.55**

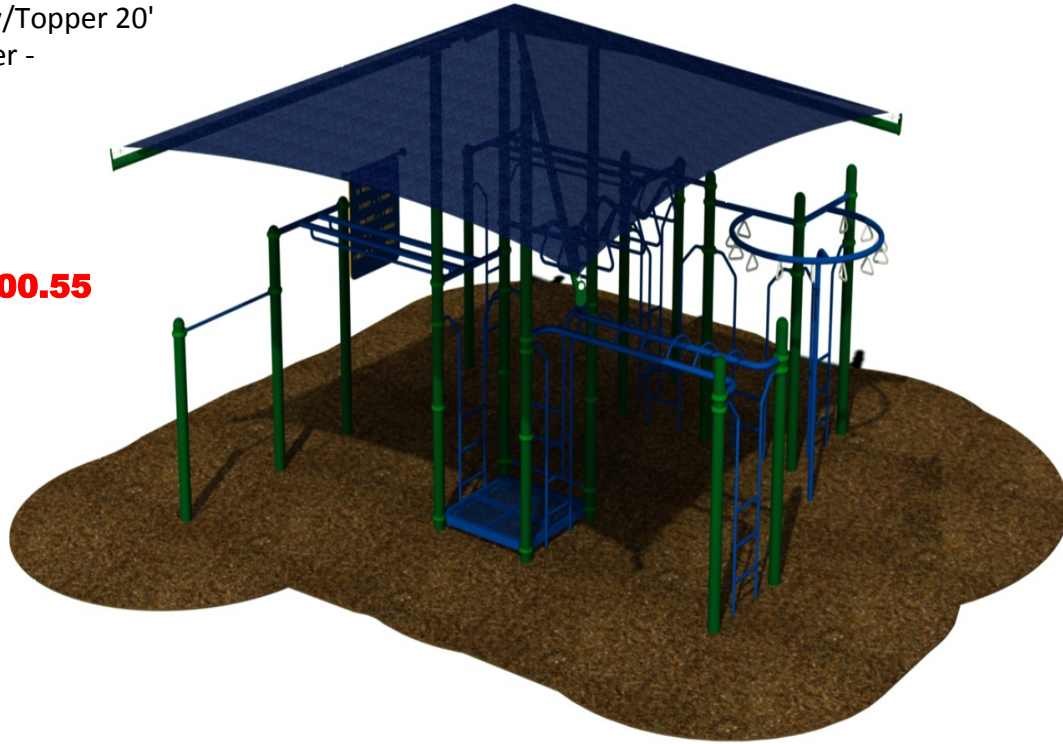

## Brookside Shade Structure & Umbrella Costs

- Install 2 Umbrella's – (1 @ 26' Umbrella) On the Primary Play Structure (1 @ 20' Umbrella) On the Fitness Area Structure –
  - \$23,684.48 (includes Umbrella and Structure Modifications)
- 4 Point Sail Shade Structure - Asphalt Play Area –
  - \$45,589.28 (includes Shade Structure and Installation)
- ADA Access Upgrades at Asphalt Play Area –
  - \$13,550.00 (estimate)

Total Cost: **\$82,823.76**



# Oak Hills – Shade Structures



**4 point Hypar Sail @ \$77,286.10 plus ADA upgrades @ \$4100.00 = \$81,386.10**

# Oak Hills

## 4 Point Hypar Sail Shade Structure

- Structure Size - 45' x 50'
- Number of Posts - 6
- Number of Fabric Tops - 2
- Fabric Type - Colourshade FR
- Fabric Color - Steel Color
- Post Attachment Method - Embed
- Entry Height - 12
- Wind load - 85 mph
- Total :

**\$77,286.10**

Main Play Area





# Oak Hills

## Minimum ADA Required w/Structures



90 SF of new sidewalk to pit (\$500)  
200 SF of sub base (\$1000)  
200 SF of PIP (\$2,600)

**Estimate \$ 4,100.00**



# Red Oak- Shade Structures



**4 Point Sail @ \$49,886.18 and 3 Point Sail @ \$31,291.05 = \$81,177.23, plus  
ADA upgrades on Fitness Rubber Service @ approx. \$700.00 = \$81,877.23**

## **Total Cost: Shade Structures, Umbrellas and ADA Access Modifications**

• Brookside	\$82,823.76
• Oak Hills	\$81,386.10
• Red Oak	<u>\$81,877.23</u>
<b>TOTAL</b>	<b>\$246,087.09</b>